

INPUT: MANY LOGGERS  
OUTPUT: ONE FILE

**BLUEPIRAT**  
:BY MAGNA



## CONNECTED ONE VIRTUAL DEVICE

Use System Link to create a system perfectly tailored to your needs: Connect several blue PiraT Mini and one blue PiraT2 via Ethernet. Always new – flexible, simple, long-term reliable and future-proof.

Manage your logger network easily via System Client. Even software updates for several loggers are possible – with just a few clicks.

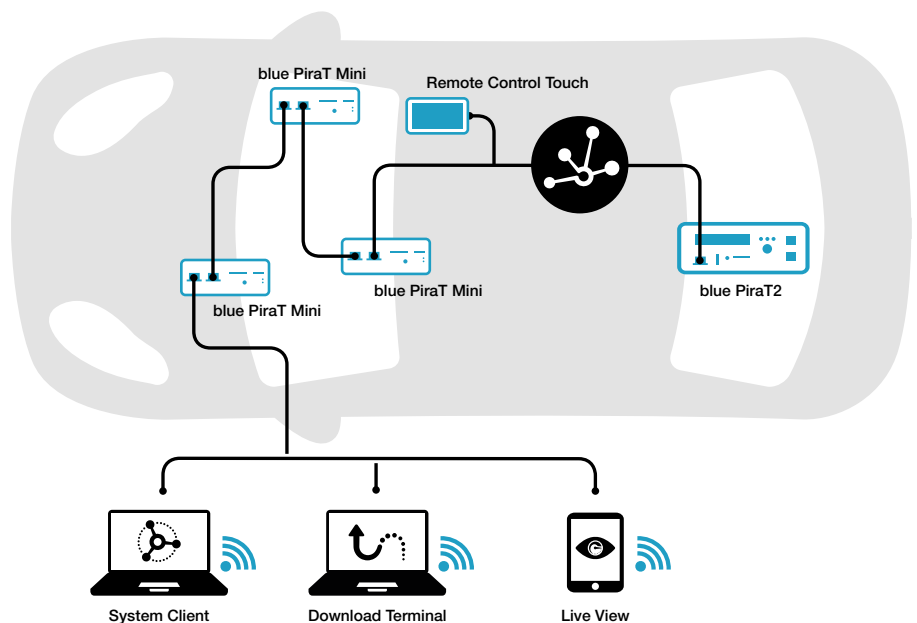

### Four easy steps.

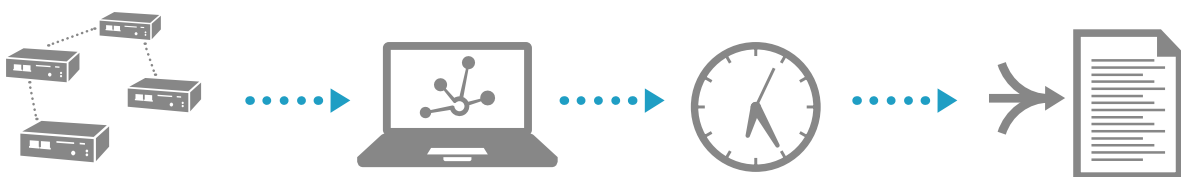

#### Connect.

Simply connect your data loggers via Ethernet. System Link supports all interfaces (e.g. MOST, Ethernet/BroadR-Reach, CAN, LIN, FlexRay) – now and in the future.

#### Configure.

Assemble your logger system on the PC exactly as you need it. System Link makes configuration of the connected interfaces and data loggers easier than ever.

#### Synchronize.

Rely on the unique time synchronization between the connected data loggers. With a resolution of 1  $\mu$ s, it guarantees maximum recording precision.

#### Read out.

You get all data sets of the selected interfaces either in individual files or in one file. Everything at a glance, without the tedious collating of individual files.